

# SITE PLAN OF

RESIDENTIAL FLAT BUILDING AT R.S. DAG NO-637 & 643,  
L.R. DAG NO.-698 & 704, L.R. KH NO-2013,2747,2752,2753,2754,  
2856,2859,2877, 3210,3211 & 3212, MOUZA-ANDUL, J.L.NO-29,  
P.S-SANKRAIL, DIST-HOWRAH.

PROJECT NAME:-SARFA RIVIERA,

PROJECT ADDRESS:-ANDUL-MOURI PURBAPARA, HOWRAH



OPEN LAND

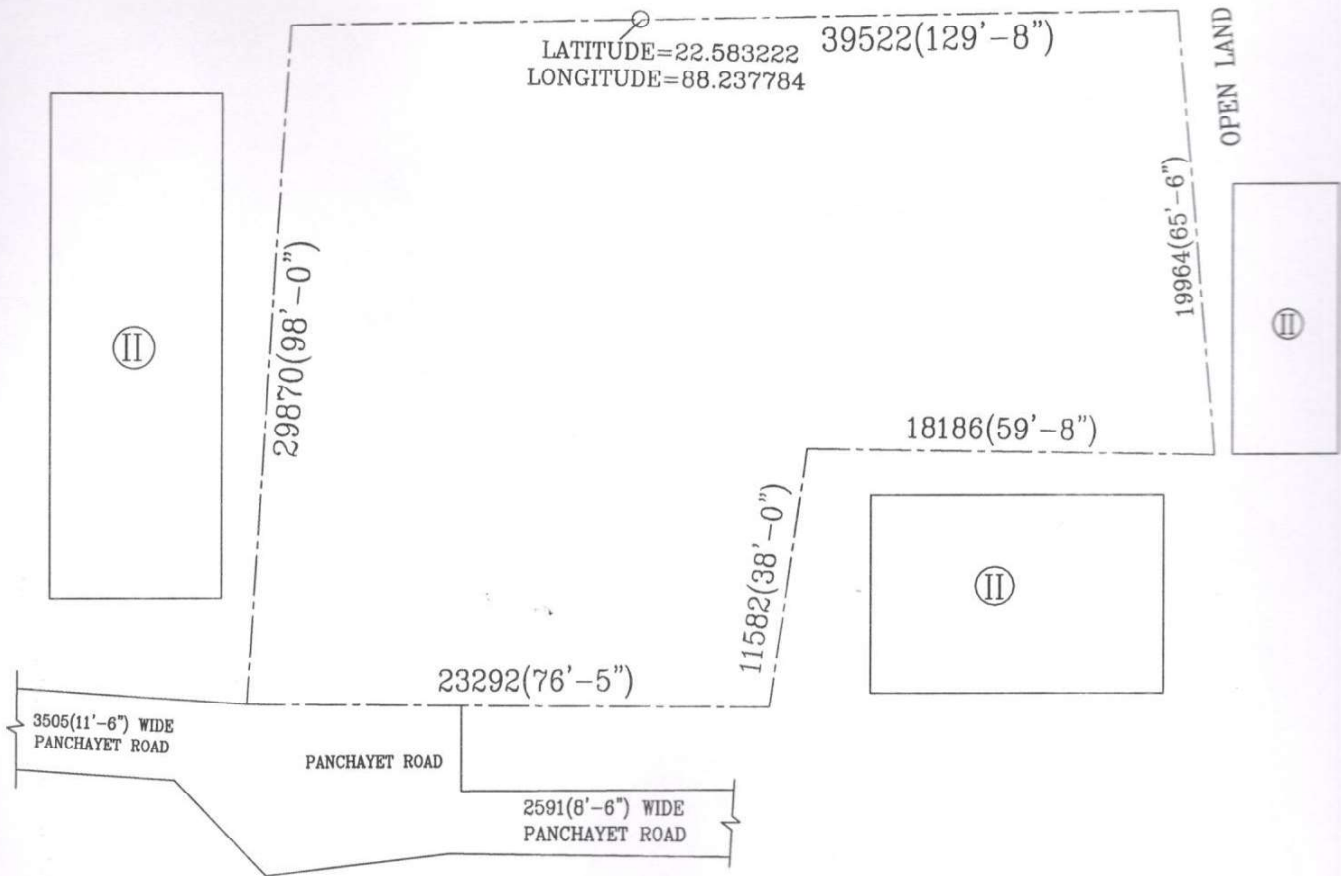

SARFA CONSTRUCTION PRIVATE LIMITED

*Md. Sabid*  
Director